

Device Installation Guide

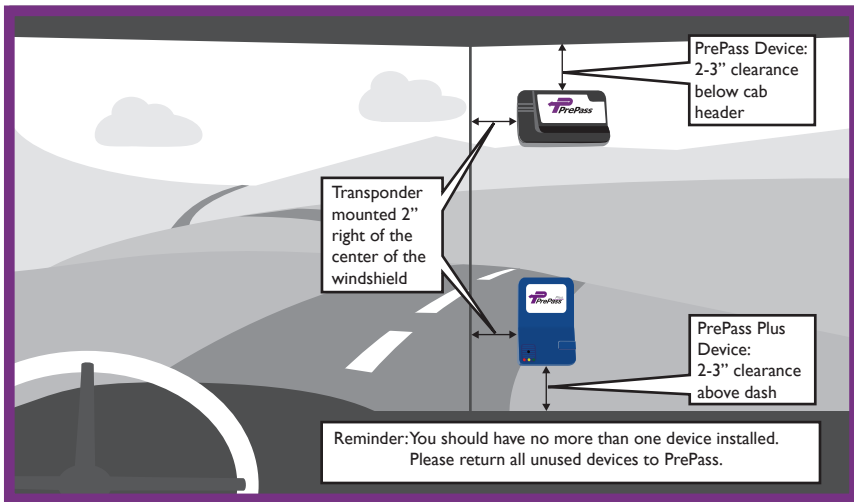

Device Installation Guide

A. Location of Transponders

The transponder is designed to be mounted directly onto the interior windshield where it can be observed by the driver without obstructing their view of the road. As shown in the diagram, installation for each type of device is as follows:

PrePass Device: The transponder must be mounted at least two inches (but not more than three inches) from the **top** center of the windshield and positioned so that the PrePass label and red and green lights face the driver.

PrePass Plus Device: The transponder must be mounted at least two inches (but not more than three inches) from the **bottom** center of the windshield and positioned so that the PrePass Plus label and lights are visible to the driver.

B. Mounting Procedure

Before securing the transponder onto the designated area, make sure the windshield area is thoroughly cleaned. Remove the backing tape from the adhesive strip(s) located on the back side of the device. Firmly press the transponder with exposed adhesive facing the windshield surface.